

SUBJECT: 7.3L Power Stroke®/T444E High-Pressure Pump Seal Replacement Kit

The AP0002 G2.8 Injector Seal Kit for 6.0 L Injectors includes a high-pressure oil inlet seal and retaining clip.

Because removal of the clip that retains the oil inlet seal and ferrule can be problematic without special tools, we're offering the following alternative solutions to replace the seal in the field:

1. Replace the seal without removing the retaining clip.
 - a. Remove the existing seal using a small screwdriver blade.
 - b. Lubricate a new seal with a suitable assembly lubricant (i.e., Stanadyne® part number 22204 Assembly Lubricant) and work it into its seal bore with a small screwdriver blade. Make sure the seal is in place below the ferrule.

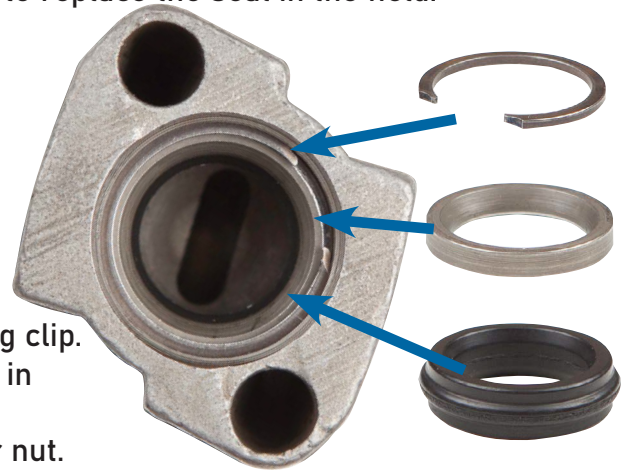

- OR
2. Remove the retaining clip, then replace the seal and retaining clip.
 - a. To hold the injector for this procedure, place the injector nut in a six point 27 mm socket supported in a vise.

Caution: Using a twelve point socket could damage the injector nut.

- b. Remove the existing seal using a small screwdriver blade.
 - c. The ferrule should drop to the bottom of the seal bore. If necessary, push the ferrule down with a small screwdriver blade.
 - d. Using a sharp center punch (i.e., Snap-On® part number PPC714B, shown below), strike the clip near the center point between its two ends. If done properly, the clip ends will fold inward.



- e. Pry the clip out of the bore with a small screwdriver blade or needle nose pliers.
 - f. With your fingers or outward opening pliers, remove the ferrule and set aside to reuse.
 - g. Lubricate a new seal with a suitable assembly lubricant (i.e., Stanadyne part number 22204 Assembly Lubricant) and insert it in its seal bore.
 - h. Install the ferrule above the seal. Important: The chamfer of the ferrule faces up toward the retaining clip.
 - i. Install a new retaining clip using needle nose pliers. Start one end of the clip in its groove, then use leverage against the stator housing to work the other end in place.

R1-Added Reference to the Use of a Six Point 27 mm Socket

For more information visit

AlliantPower.com

Alliant Power Technical Support: 800.735.9775 | techsupport@AlliantPower.com