

## FORD



### Each kit contains:

- Fuel Injectors
- High-Pressure Fuel Pump
- High-Pressure Fuel Lines
- Installation Gaskets
- Fuel Rails
- Fuel Filters

### AP64920

Year Range	Model	Application Data	OEM Cross Reference
2008-2010	6.4L Power Stroke	F-250/350/450/550	DKT081064

For fitment verification please contact Technical Support with complete VIN number.

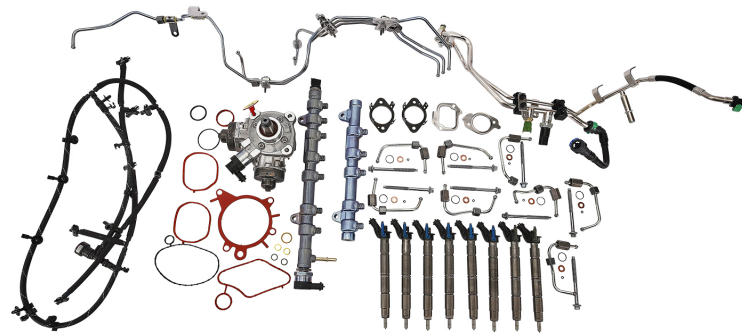

### Each kit contains:

- Fuel Injectors
- CP4 Fuel Injection Pump
- Installation Gaskets
- High-Pressure Fuel Lines
- Fuel Rails
- Fuel Supply and Return Lines

### AP57000

Year Range	Model	Application Data	OEM Cross Reference	Notes
2011-2014	6.7L Power Stroke	F-250/350/450/550 Pickup	EC3Z9B246C	Fits up to 2014 pickup models.
2011-2016		F-350/450/550 Cab Chassis		Fits up to 2016 cab chassis models.

For fitment verification please contact Technical Support with complete VIN number.

## IT'S MORE THAN JUST A BOX

- Genuine OE or OE equivalent components
- Single part number saves time and sourcing
- Best-in-class technical support
- 2-year, unlimited mileage warranty

# THE TOTAL PACKAGE

INSTALLATION GASKETS | FUEL INJECTORS  
FUEL PUMPS | FUEL RAILS

## FORD

### Each kit contains:

- Fuel Injectors
- CP4 Fuel Injection Pump
- Installation Gaskets
- High-Pressure Fuel Lines
- Fuel Rails
- Fuel Supply and Return Lines

### AP57001

Year Range	Model	Application Data	OEM Cross Reference	Notes
2015-2016	6.7L Power Stroke	F-250/350	FC3Z9B246F	Fits F Series pickup only.

For fitment verification please contact Technical Support with complete VIN number.

### Each kit contains:

- Fuel Injectors
- CP4 Fuel Injection Pump
- Installation Gaskets
- High-Pressure Fuel Lines
- Fuel Rails
- Fuel Supply and Return Lines

### AP57002

Year Range	Model	Application Data	OEM Cross Reference
2017-2019	6.7L Power Stroke	F Series	HC3Z9B246B

For fitment verification please contact Technical Support with complete VIN number.

### Each kit contains:

- Fuel Injectors
- CP4 Fuel Injection Pump
- Installation Gaskets
- High-Pressure Fuel Lines
- Fuel Rails
- Fuel Supply and Return Lines
- Fuel Cooler
- Fuel Filters

### AP57003

Year Range	Model	Application Data	OEM Cross Reference	Notes
2020-2022	6.7L Power Stroke	F-250/350/450/550	LC3Z9B246A	Pickup and cab chassis

For fitment verification please contact Technical Support with complete VIN number.

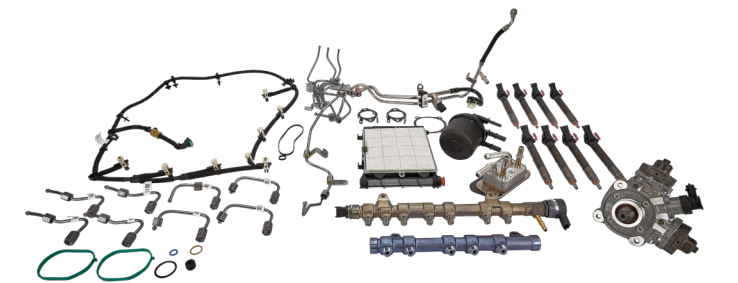
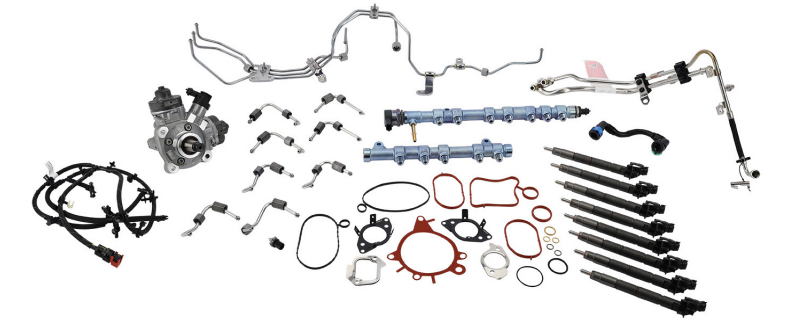
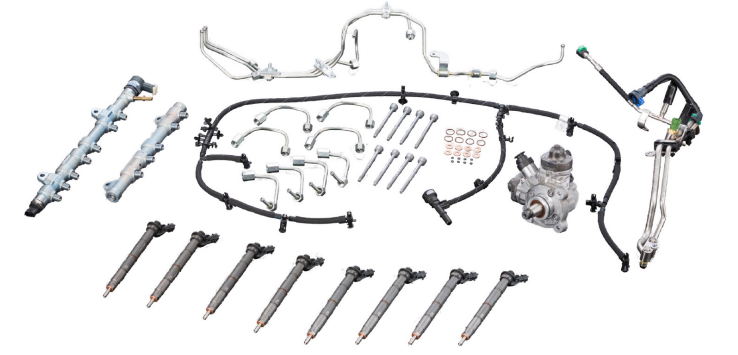

**RAM CUMMINS**



**Each kit contains:**

- Fuel Injectors
- CP3 Injection Pump
- High-Pressure Fuel Lines
- Injector Feed Tubes
- Intake Gasket
- Fuel Rail

**AP57006**

Year Range	Model	Application Data	OEM Cross Reference
2013-2018	Ram 6.7L	Ram 2500, 3500 (Pickup truck)	DKT131867

For fitment verification please contact Technical Support with complete VIN number.

**GM 6.6L DURAMAX**

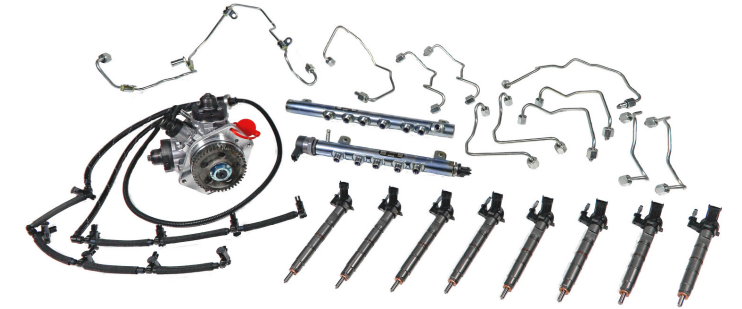

**Each kit contains:**

- Fuel Injectors
- CP4 Fuel Injection Pump
- High-Pressure Fuel Lines
- Installation Gaskets
- Fuel Rails
- Fuel Supply and Return Lines

**AP57004**

Year Range	Model	Application Data	OEM Cross Reference
2011-2016	Silverado & Sierra	6.6L LML Duramax	DKT1116LML

**AP57005**

Year Range	Model	Application Data	OEM Cross Reference
2011-2016	Express & Savana	6.6L LGH Duramax	DKT1116LGH

For fitment verification please contact Technical Support with complete VIN number.

**Each kit contains:**

- Fuel Injectors
- High-Pressure Fuel Pump
- High-Pressure Fuel Lines
- Installation Gaskets
- Fuel Filter
- Fuel Cooler
- Fuel Rails
- Fuel Supply and Return Lines

**AP54820**

Year Range	Model	Application Data	OEM Cross Reference
2017-2019	Silverado & Sierra	6.6L L5P Duramax	<b>REXCLUSIVE</b>

**AP54821**

Year Range	Model	Application Data	OEM Cross Reference
2019-2022	Silverado 4500, 5500, 6500HD	6.6L L5D Duramax	<b>REXCLUSIVE</b>

For fitment verification please contact Technical Support with complete VIN number.



**NAVISTAR**

**AP54821**

Year Range	Model	Application Data	OEM Cross Reference
2019-2022	International 6.6	CV Series	<b>REXCLUSIVE</b>

For fitment verification please contact Technical Support with complete VIN number.